

## Limited Warranty

**First Alert**<sup>®</sup>

M08-164258\_164258\_REV B  
ENGLISH

BRK Brands, Inc., ("BRK") warrants that for a period of five (5) years from the date of purchase, this product will be free from defects in material and workmanship. BRK, at its sole option, will repair or replace this product or any component of the product found to be defective during the warranty period. Replacement or repair will be made with a new or remanufactured product or component. If the product is no longer available, replacement may be made with a similar product of equal or greater value. This is your exclusive warranty.

This warranty is only valid for the original retail purchaser from the date of initial retail purchase and is not transferable. You must keep the original sales receipt. Proof of purchase is required to obtain warranty performance. The original retailer will handle the replacement. BRK dealers, service centers, or retail stores selling this product do not have the right to alter, modify or in any way change the terms and conditions of this warranty.

This warranty does not apply to the finish on the product. This warranty does not cover normal wear and tear of parts or damage resulting from any of the following: negligent use or misuse of the product, use contrary to the operating instructions, disassembly, repair or alteration by anyone other than BRK or an authorized service center, improper installation, or exposure to extremes of heat or humidity. Further, the warranty does not cover Acts of God, such as fire, flood, hurricanes and tornadoes.

BRK shall not be liable for any incidental or consequential damages caused by the breach of any express or implied warranty. BRK is also not responsible for: costs associated with removing or installing the product; damage or loss of the contents of the product; nor for the unauthorized removal of the contents; or damages incurred during shipment.

Except to the extent prohibited by applicable law, any implied warranty of merchantability or fitness for a particular purpose is limited in duration to the duration of the above Warranty Period. Some states, provinces or jurisdictions do not allow the exclusion or limitation of incidental or consequential damages or limitations on how long an implied warranty lasts, so the above limitations or exclusion may not apply to you. This warranty gives you specific legal rights, and you may also have other rights that vary from state to state, or province to province, or jurisdiction to jurisdiction.

If you have any questions that cannot be answered by reading this manual, call the Customer Service Team at (800) 323-9005.

© 2020 BRK Brands, Inc. All rights reserved. Distributed by BRK Brands, Inc. BRK Brands, Inc. is a subsidiary of Newell Brands Inc. (NASDAQ: NWL). 3901 Liberty Street, Aurora, IL 60504-8122.

[www.firstalert.com](http://www.firstalert.com)

M08-164258\_164258\_REV B

## Operation & Installation Guide

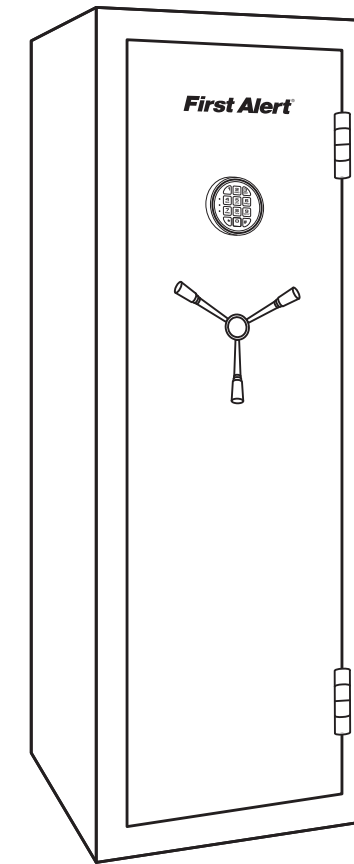

# EXECUTIVE HYBRID SAFE

Model 1041864

- Read carefully
- Keep for reference
- Do not keep inside of safe

**First Alert**<sup>®</sup>

Home and Office Security Safes

1041864

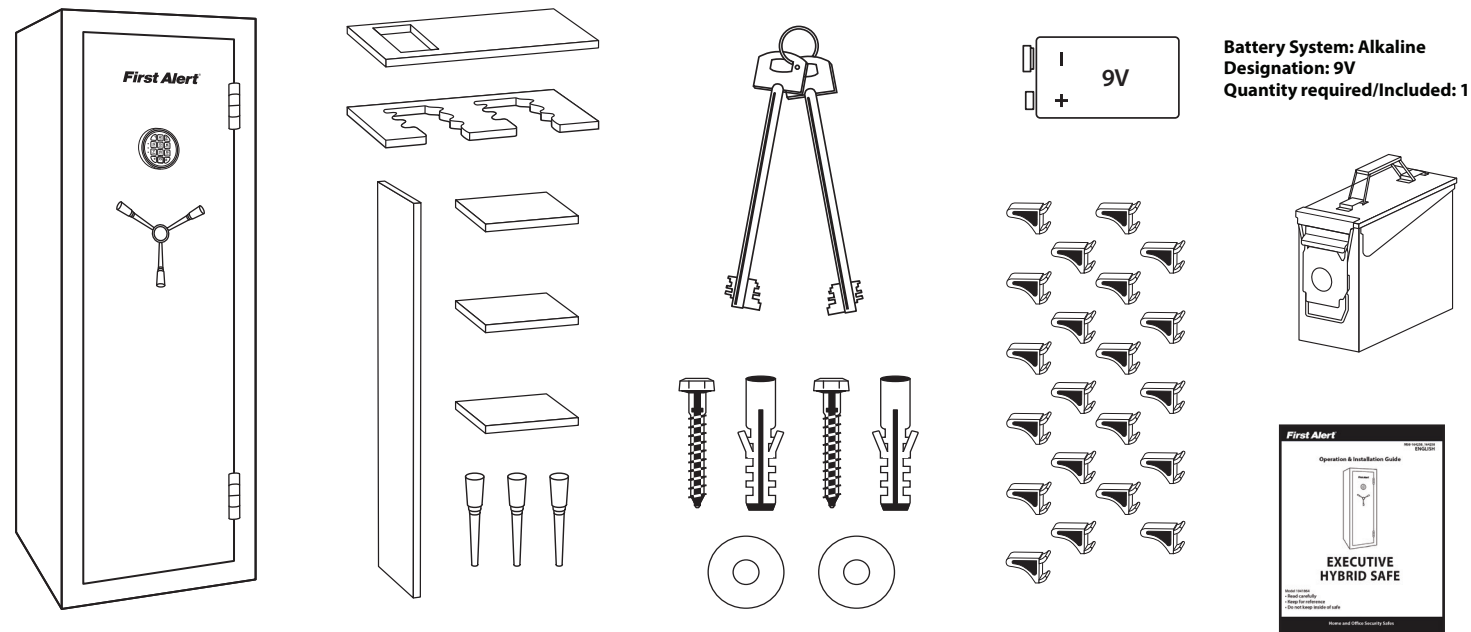

### Safe Identification Record

Model Number \_\_\_\_\_ 1

Serial Number \_\_\_\_\_ 2

Key Number \_\_\_\_\_ 3

**Digital Passcode Record**  
 Model 1041864  
 Your Passcode must be at least 3 digits and no more than 8 digits followed by the letter # or \*

									#
									*

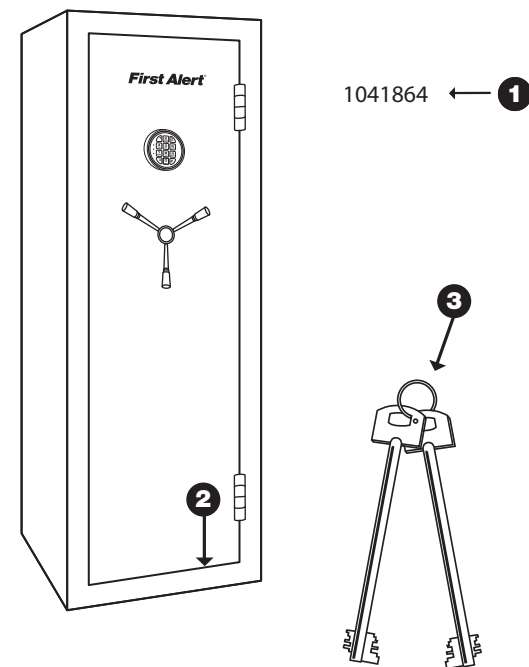

**Important:**  
 If you are missing parts, have difficulty programming your safe or have any other questions pertaining to its proper use and care, DO NOT RETURN your safe to the store. Please contact Customer Service Team at 1-800-323-9005. To assist us in serving you, please have the model number, serial number, and date of purchase available when calling.

## Installation of Safe Door Handle

Take the three metal spokes and turn counterclockwise into the hub found on the door of the safe.

## Installing the Battery

- To remove keypad, the locking tab must be pressed and held to the side (Left) while you twist the keypad counter clockwise (to remove it). Carefully hold the battery connecting cap while attaching the 9V alkaline battery (included). Then rotate clockwise the cover back in place. Be sure the wires are pushed back into the safe to avoid any pinched wires.
- Repeat above steps for battery replacement.



NOTE:

- When changing the battery, always hold the battery connecting cap while disconnecting or attaching the battery. Do not pull on the wires. Doing this could cause the power supply to become disconnected from the lock.
- When the battery runs out, the red light will flash when you press any button on the keypad. Replace the battery when the red light flashes.

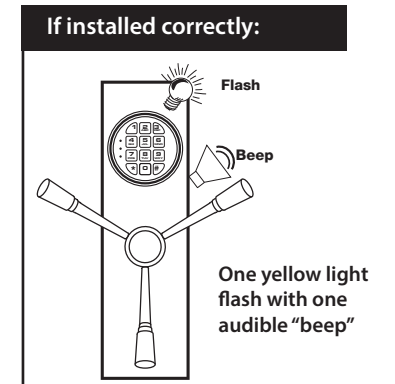

**Important:**

Clean the battery contacts in the battery compartment and on the battery before installing a new battery.

## Opening the Safe for the First Time

After installing the battery, to open an electronic lock the first time, press the following numbers/symbols on the electronic keypad in this order: **1 - 5 - 9 - #** These numbers are preset.

**NOTE: You should change the entry code as soon as possible after opening the safe to insure proper security.**

After you have entered the factory code, you will need to turn the handle clockwise to open the door. You will have 5 seconds to turn the handle before the locking mechanism is reactivated.

## Override Key Use

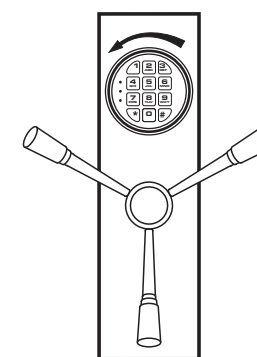

Turn lock cover as shown.

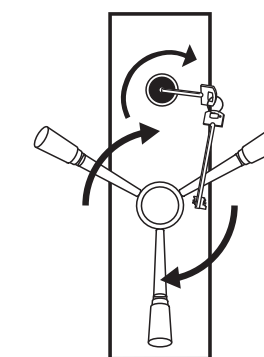

Insert key and turn clockwise and hold. Rotate handle clockwise then pull door open.

**Important:**

If key will not turn please note that there will be some resistance then you have to push the key further in to properly engage key to turn clockwise.

If the handle will not rotate clockwise after the key is turned, then rotate the handle slightly counterclockwise until it stops, then rotate clockwise again to open.

**Important:**

The override key is used to gain access to the safe if the digital lock fails to operate. This key should be stored in a secure place away from your safe.

## Programming Personal Passcode

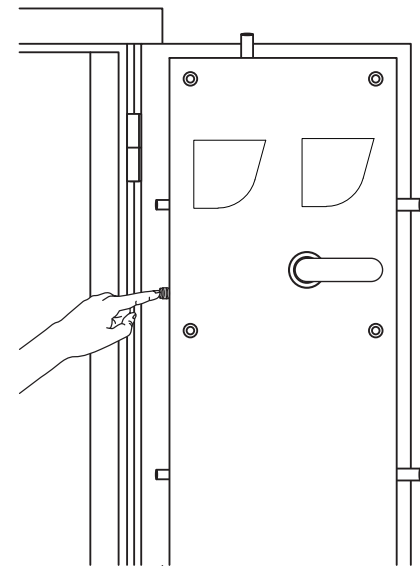

Press reset button

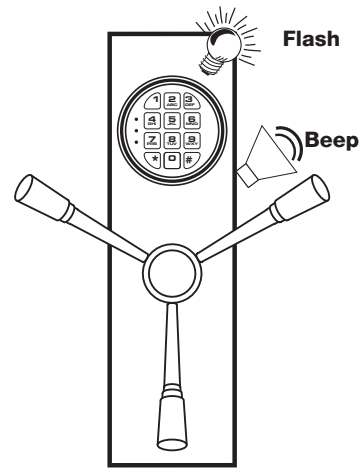

Ready light flashes along with a beep

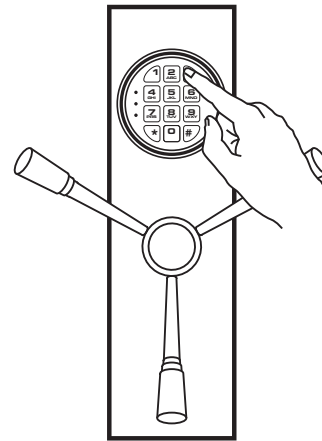

Enter new code: 3-8 digits followed by the \* key. There will be three rapid yellow LED flashes and beeps when successful.

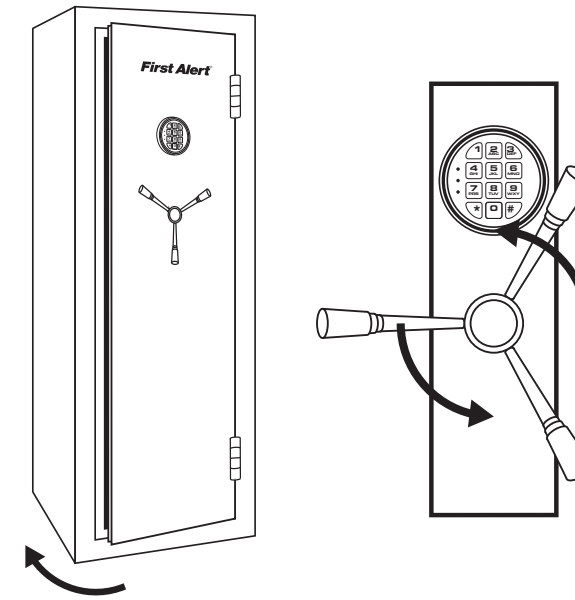

Push door closed then rotate handle counterclockwise fully into the locked position.

## Closing Safe

### TROUBLESHOOTING:

If safe fails to open with your Personal Passcode, try the following:

1. Check to see if the batteries have been installed properly and replace if necessary.
2. Lock-out may have occurred. Wait 15 minutes before trying again.
3. Contact BRK Customer Service Team.

### EMERGENCY INTERIOR ESCAPE LATCH:

Your safe is equipped with an Emergency Escape Latch to allow the safe to be easily opened from the inside in the unlikely event that someone should become locked inside the safe. To engage, pull down on the lever handle and push the door open.

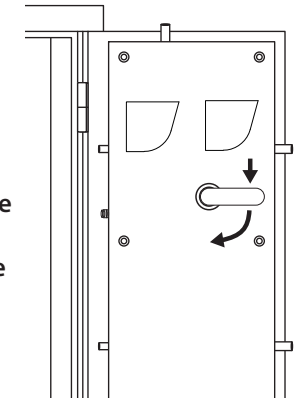

## Personal Passcode Entry

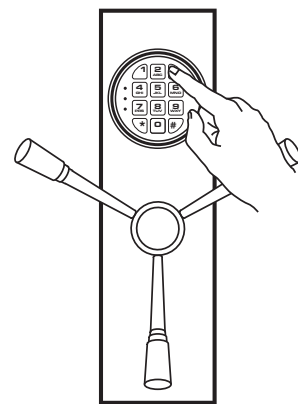

Enter new Personal Code + #

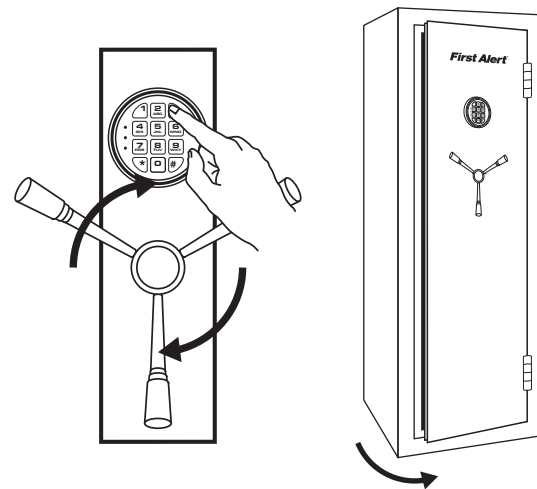

Rotate handle clockwise then pull door open

### SECURITY LOCK-OUT PERIODS:

For added security, the safe will automatically "Lock-out" entry for 20 seconds after three attempts to open with an invalid Passcode.

If the incorrect security code is entered 3 additional times, there will be a 5-minute lockout period.

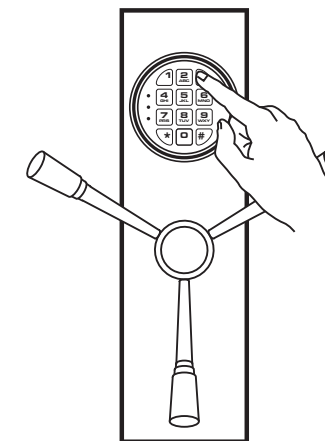

You can turn off the "beep" sound of the keypad by entering the code "\*633". You will see two green LED flashes. You now can enter the code without the beep sound.

## Turn Keypad Sound Off/On

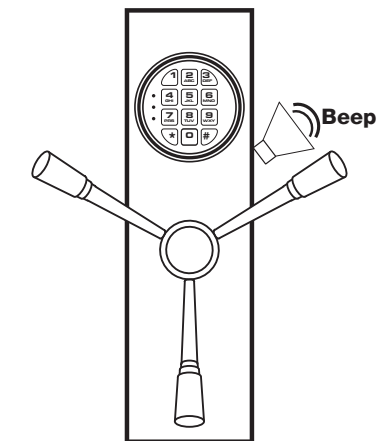

To turn on the "beep" sound, enter the code "\*66". There will be two audible tones and two green LED flashes. You can now enter the code with the beep sound.

### Important: If the handle will not turn

If the handle will not turn to the right after the green light comes on, first turn the handle slightly back to the left until it stops, then turn upwards to the right again to open.

## Shelf install

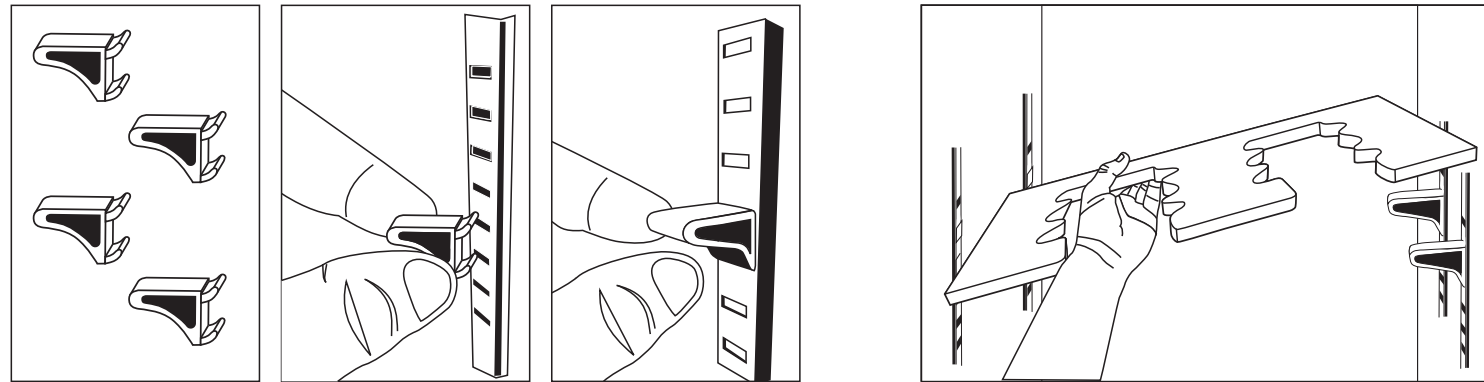

## Floor Mounting

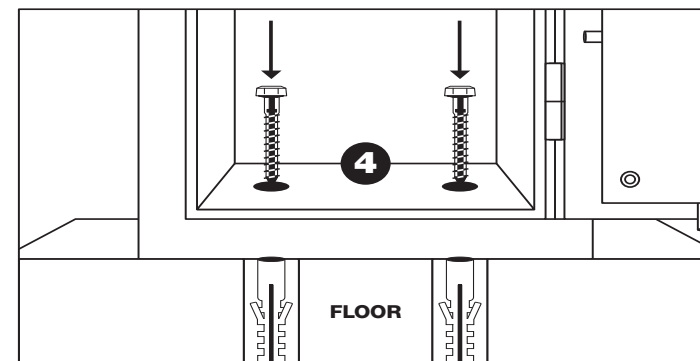
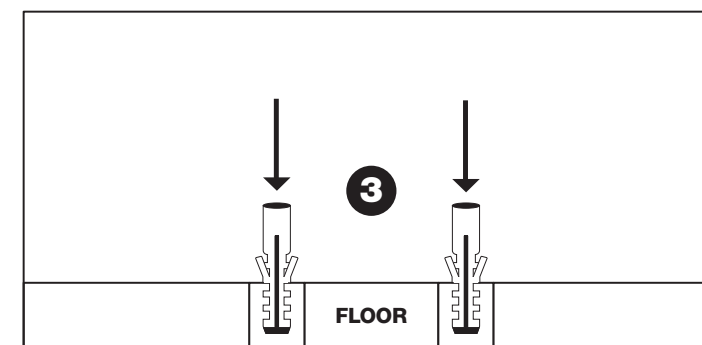
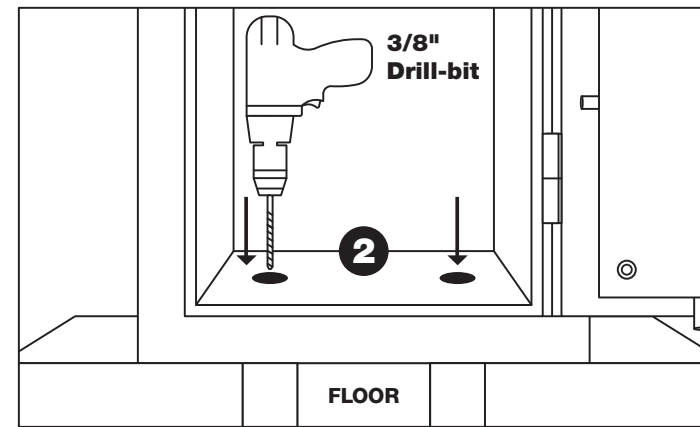
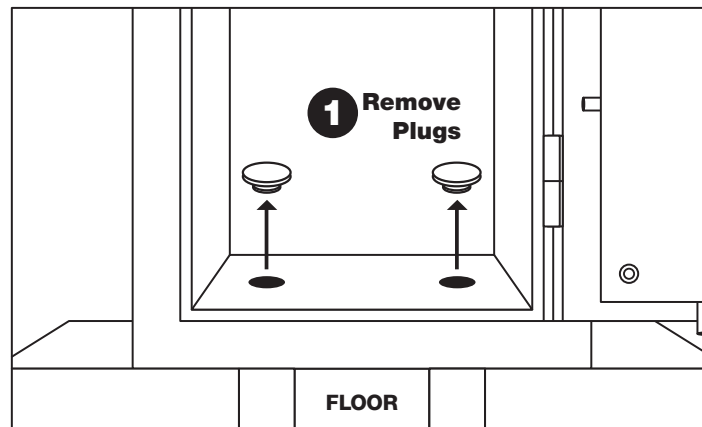

## Safe Care and Maintenance

When properly maintained, your safe will continue to operate and accurately read the authorized Passcode for many years. In order to ensure optimum performance of your safe, please follow these simple precautions:

### Battery Maintenance

- 1 Always purchase and use a 9V Duracell or Energizer battery.
- 2 Replace battery at least once a year or sooner depending on amount of use.
- 3 Always clean the battery contacts in the battery compartment and on the battery before installing new battery.
- 4 Always make sure battery matches the polarity (+ and -) signs in the open battery compartment.
- 5 If your safe will not be used for an extended period of time, it is recommended that you remove the battery.
- 6 Always promptly remove and properly discard of used battery.

**Clean Hands** – Never attempt to operate the digital keypad if your hands have excessive dirt, debris or liquids on them.

**Clean Safe** – To clean the surface of your safe, it is recommended that you use a mild cleaner (e.g., window cleaner) to avoid scratching or discoloring the surface. Always wipe dry and NEVER use abrasive cleansers on the safe or digital keypad.

**Moisture** – We recommend that you place delicate items such as pictures or intricate jewelry into an air-tight container before storing them in your safe. Avoid placing your safe in areas of high humidity. For optimum performance, the safe should be opened and aired out for at least 20 minutes every two weeks.

For future reference, store this Operation and Installation Guide in a secure area away from the safe. DO NOT DISCARD!

In order to obtain warranty service information, contact the Customer Service Team at 1-800-323-9005. To assist us in serving you, please have the model number, serial number, and date of purchase available when calling.

Please call us at 1-800-323-9005 to establish a warranty return set-up, or for a list of additional replacement parts we carry.

If you lose the safe key, you can purchase a copy replacement key from BRK Brands, Inc. You must supply the following information to assure accurate processing:

- Name / Address / Telephone.
- Safe Model Number / Serial Number.
- Key Number (located on the key and on the Emergency Override Key lock).
- Notarized statement of ownership. Visit [www.firstalert.com](http://www.firstalert.com) to download the notarized statement of ownership.
- For replacement keys, indicate number of keys requested.
- Method for how you would like to receive the keys.

Please send all the information via fax at 1-800-603-2878, email [Notaryletter@firstalert.com](mailto:Notaryletter@firstalert.com), or mail First Alert, Inc., 3901 Liberty Street Aurora, IL 60504-8122.

Checks or Money Orders are required for orders received by mail and should be made payable to First Alert. Contact our Customer Service Team for costing information prior to ordering.

### Mail to:

First Alert  
Attn: Customer Service Team  
3901 Liberty Street, Aurora, IL 60504-8122